

6th Avenue Pedestrian Enhancements

- *Study Information*
- *Preferred Alternative*
- *Cost Estimates*



URS

6th Avenue Pedestrian Enhancements

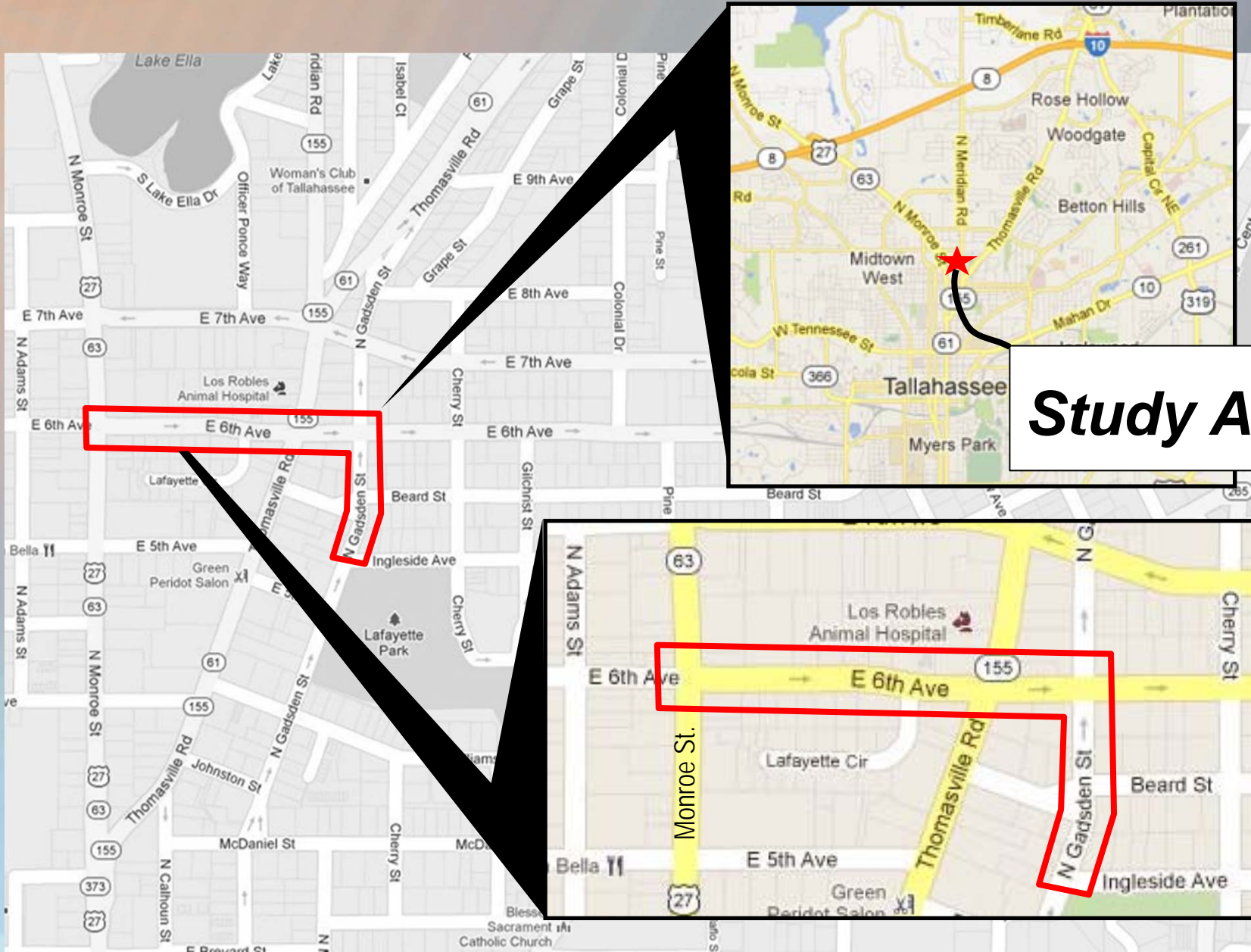

Study Area

6th Avenue Pedestrian Enhancements



6th Avenue Pedestrian Enhancements

Existing Sidewalks

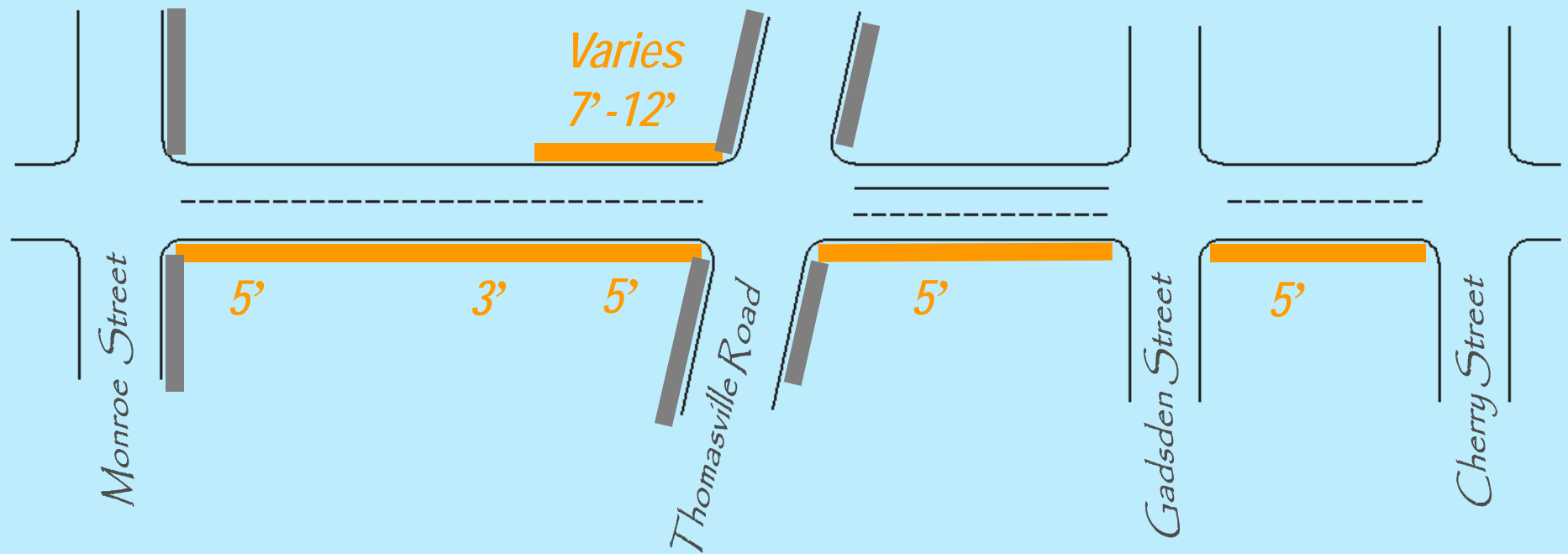

6th Avenue Pedestrian Enhancements

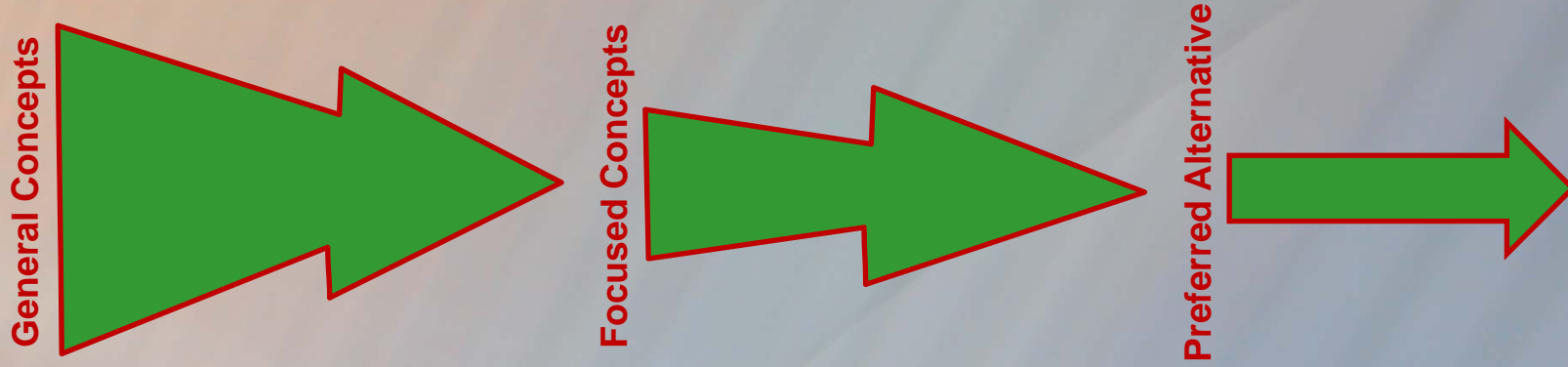

Project Milestones

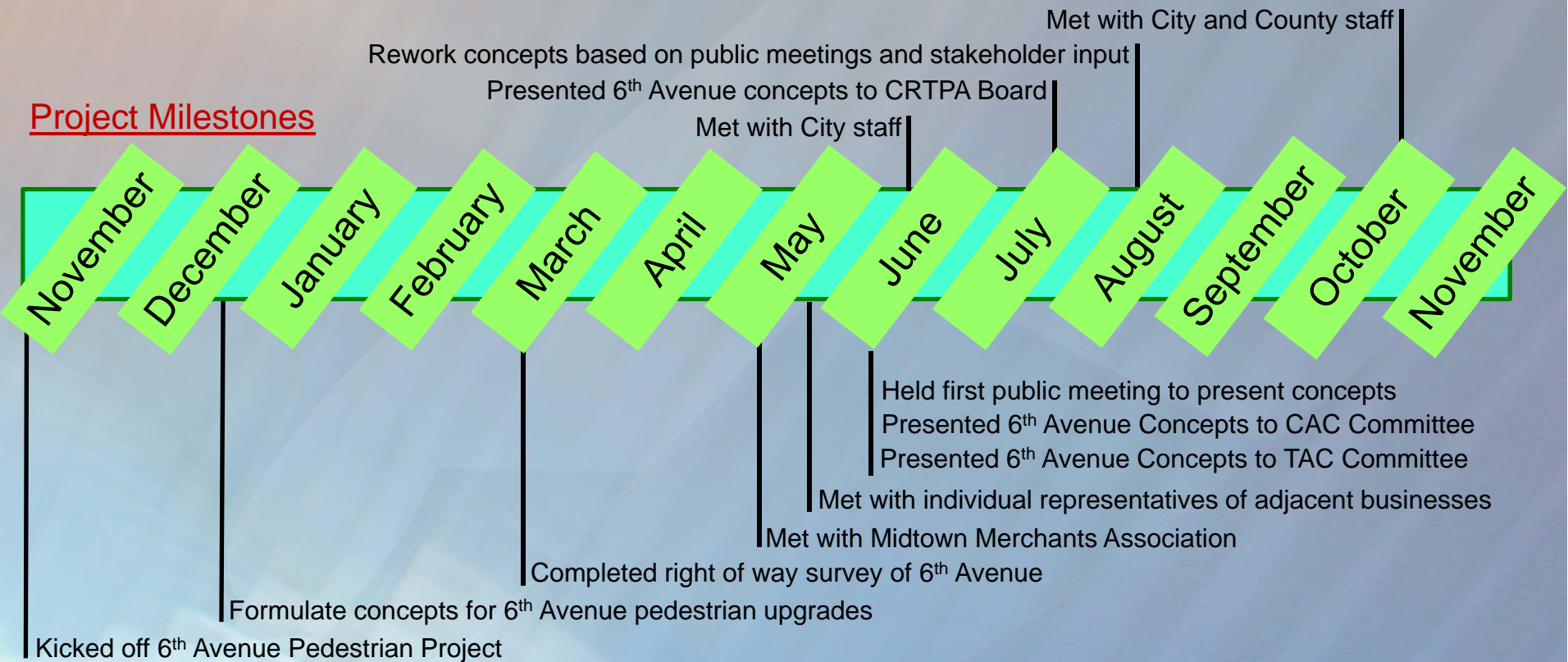

6th Avenue Pedestrian Enhancements

After initial feedback, two concepts developed.

The Preferred Alternative incorporates Concept Two plus additions and changes based on stakeholder input.

Concept Alternative One

- *Lane reduction from Monroe to Lafayette*
- *Lane reduction from Thomasville to Gadsden*
- *Sidewalks both sides of 6th Avenue*
- *Raised intersection at Thomasville Road*
- *Rebuild wall between Thomasville and Gadsden*

Concept Alternative Two

- *Lane reduction from Thomasville to Gadsden*
- *Sidewalks both sides of 6th Avenue*
- *Raised intersection at Thomasville Road*
- *Rebuild wall between Thomasville and Gadsden*

6th Avenue Pedestrian Enhancements

Preferred Alternative

- ***Lane reduction from Thomasville to Gadsden***
- ***Sidewalks both sides of 6th Avenue***
- ***Raised intersection at Thomasville Road***
- ***Raised intersection at Gadsden Street***
- ***Utilize existing wall between Thomasville and Gadsden***
- ***Sidewalk along Gadsden down to Ingelside Avenue***
- ***Mill & Resurface 6th Avenue from Monroe to Gadsden***

6th Avenue Pedestrian Enhancements

Existing Sidewalks

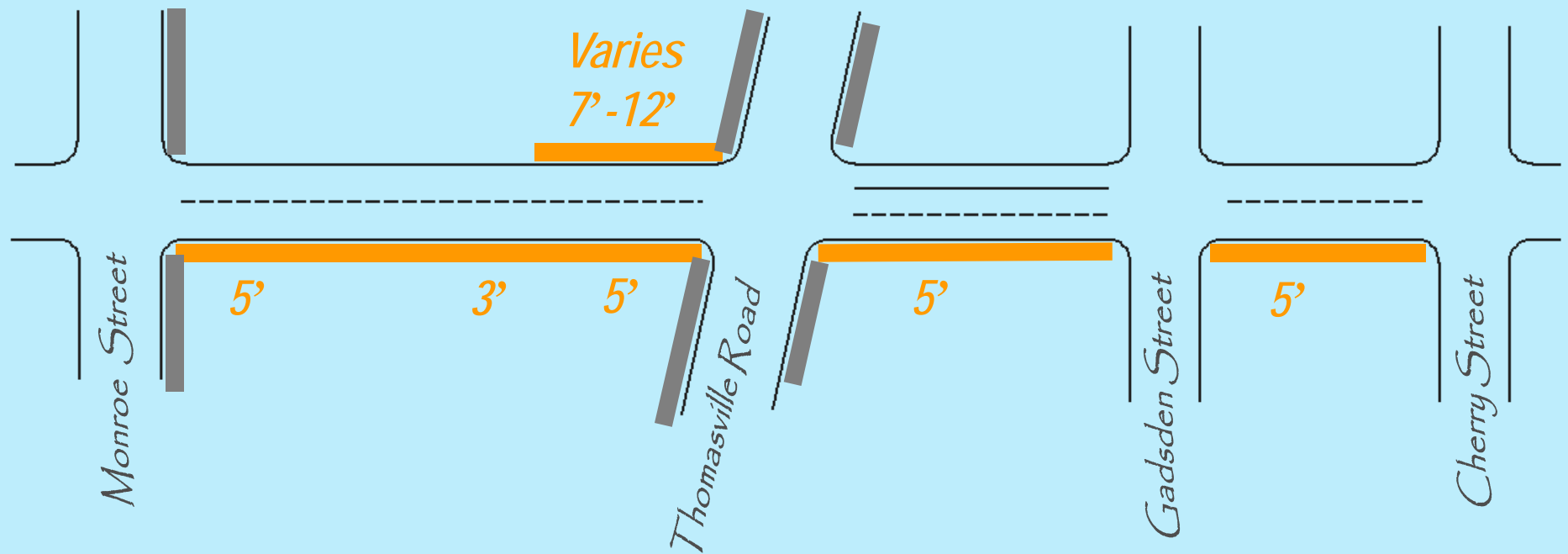

6th Avenue Pedestrian Enhancements

Preferred Alternative

Node Definition
Traffic Calming
Raised Intersections

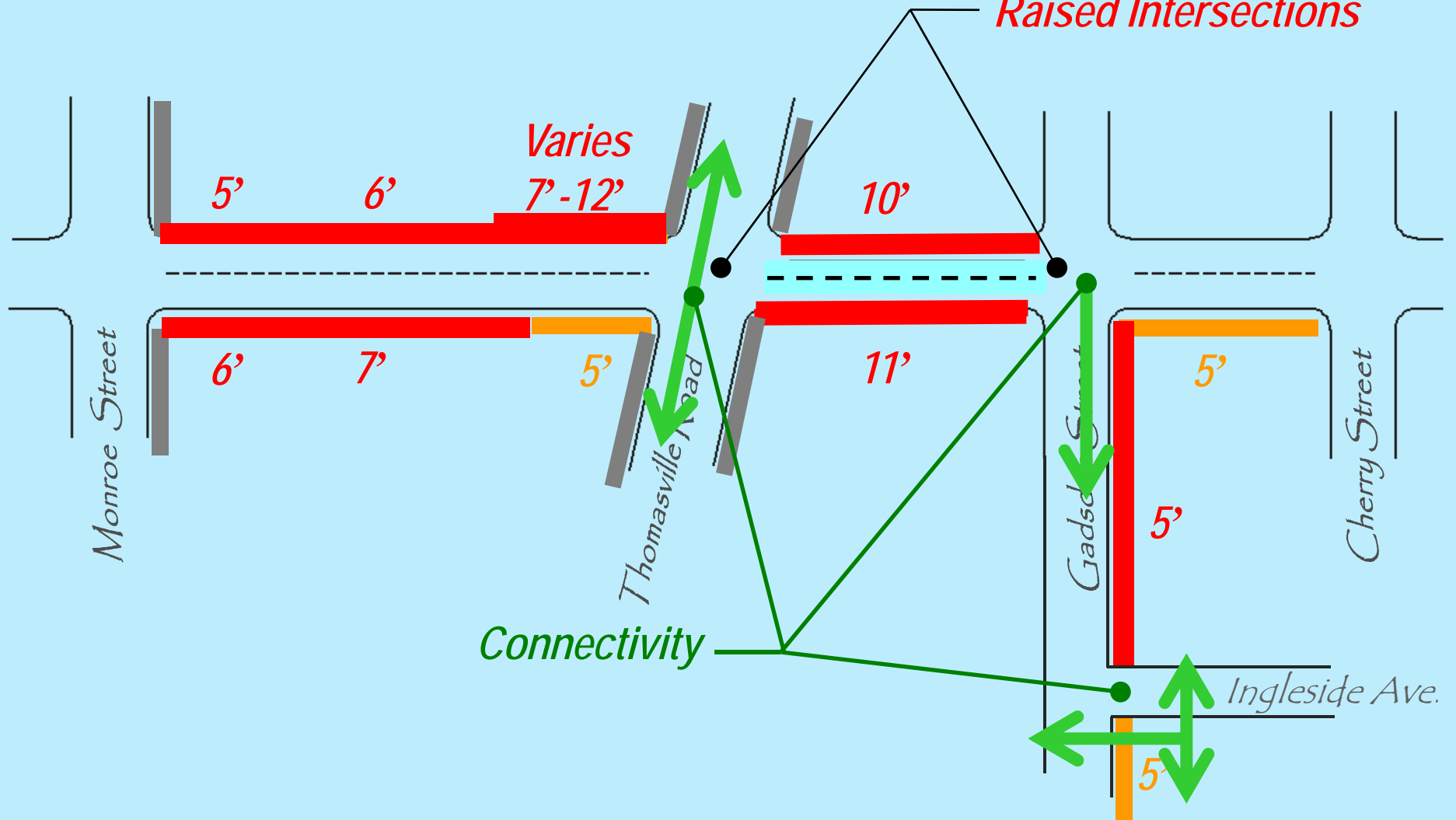

6th Avenue Pedestrian Enhancements



6th Avenue Pedestrian Enhancements



6th Avenue Pedestrian Enhancements

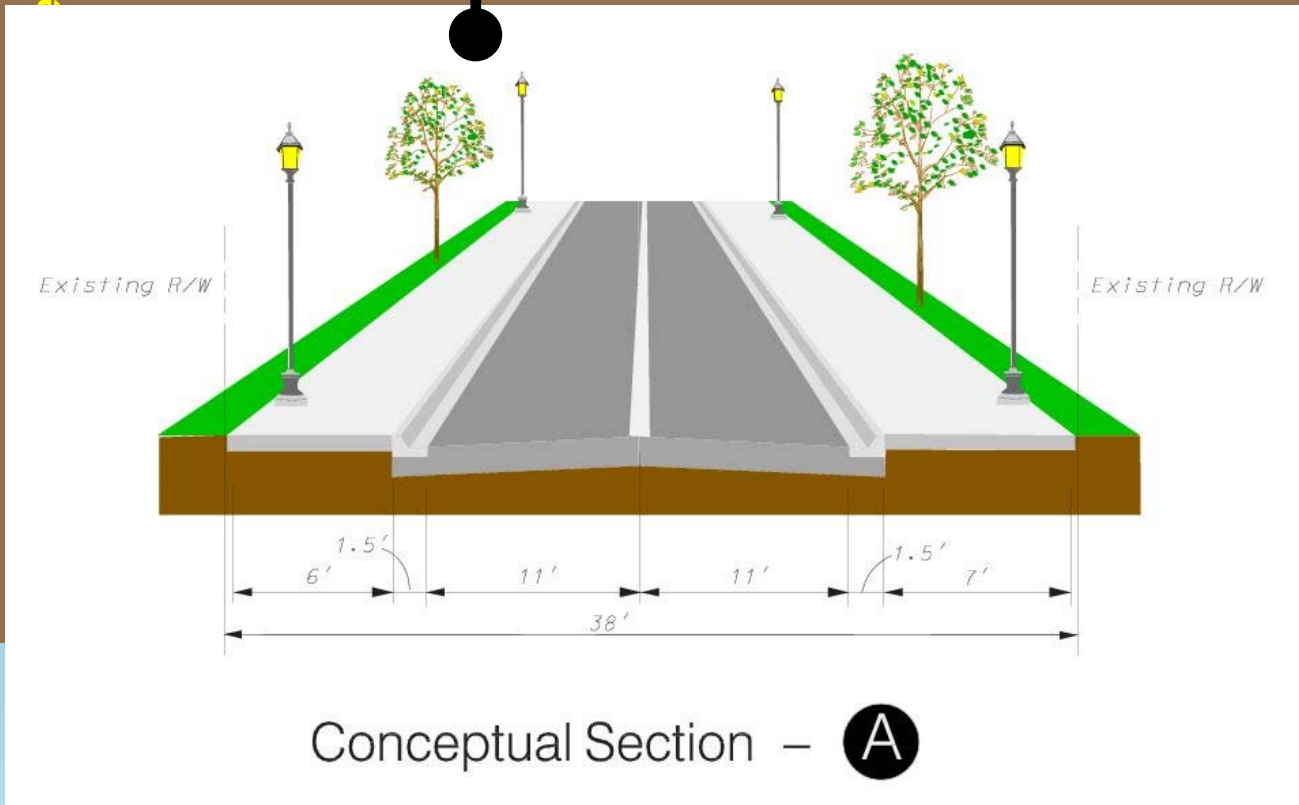
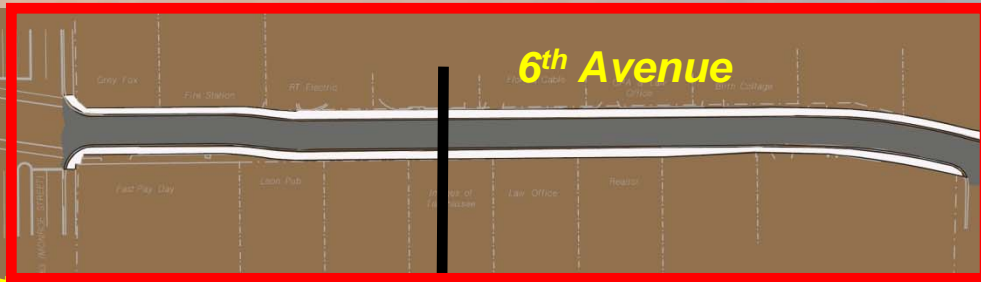

6th Avenue Pedestrian Enhancements



Image Date: April 2011

Existing Entrance from Monroe – 6th Avenue Looking West

6th Avenue Pedestrian Enhancements



Proposed Entrance from Monroe – 6th Avenue Looking West

6th Avenue Pedestrian Enhancements

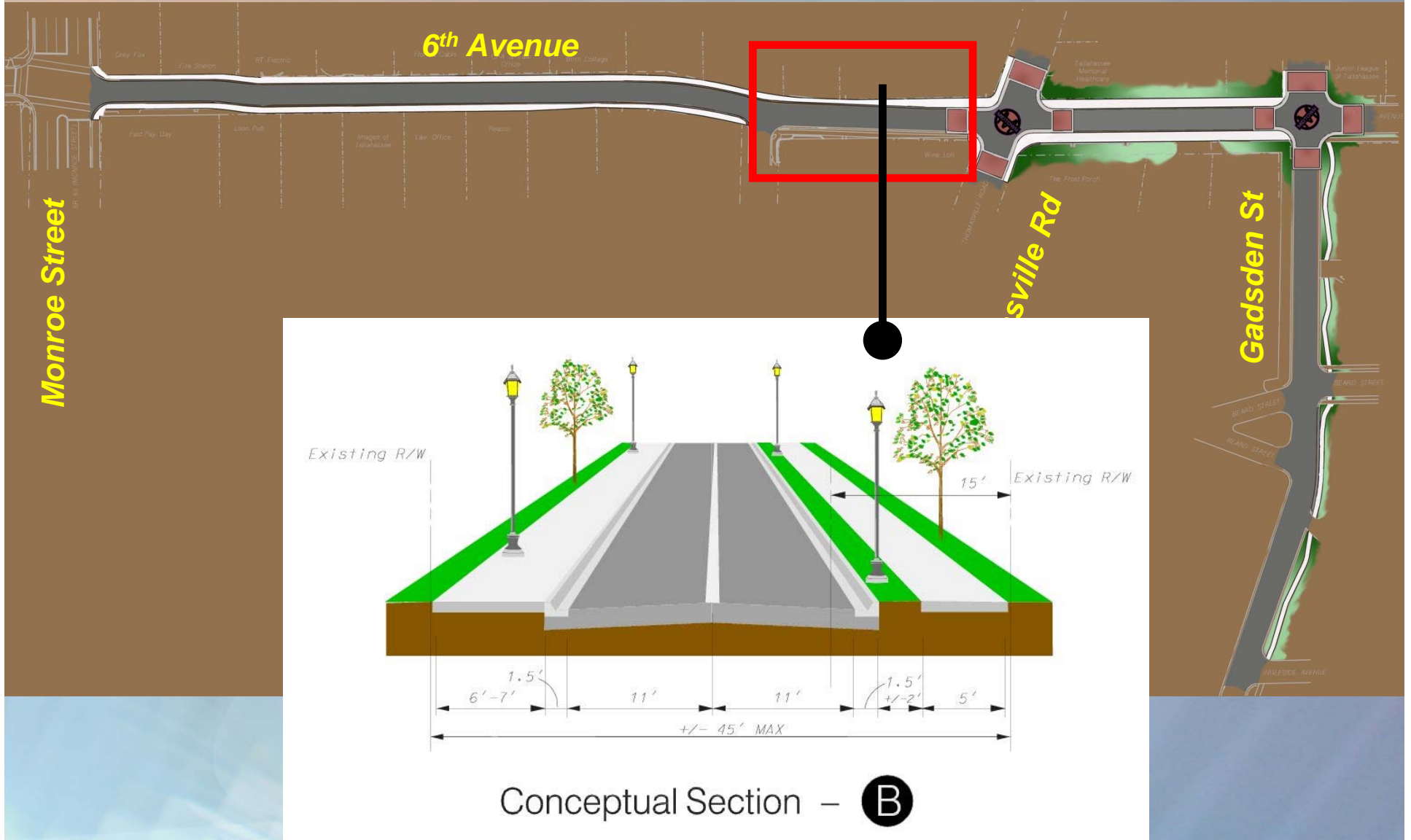

6th Avenue Pedestrian Enhancements

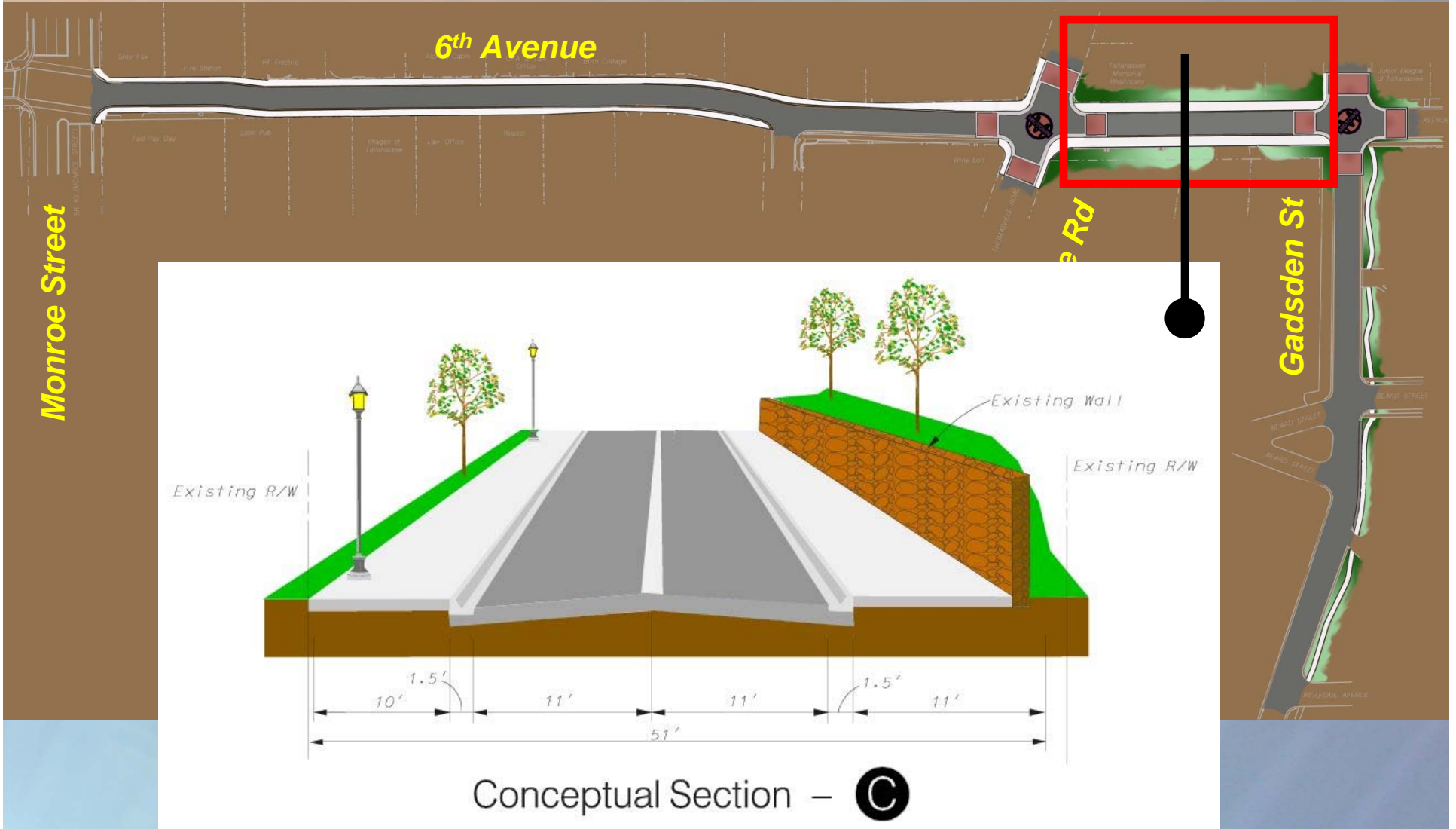

6th Avenue Pedestrian Enhancements

Existing Lane Configuration

Traffic analysis performed to determine demand for current turn lane and traffic operations for segment with no dedicated turn lane.

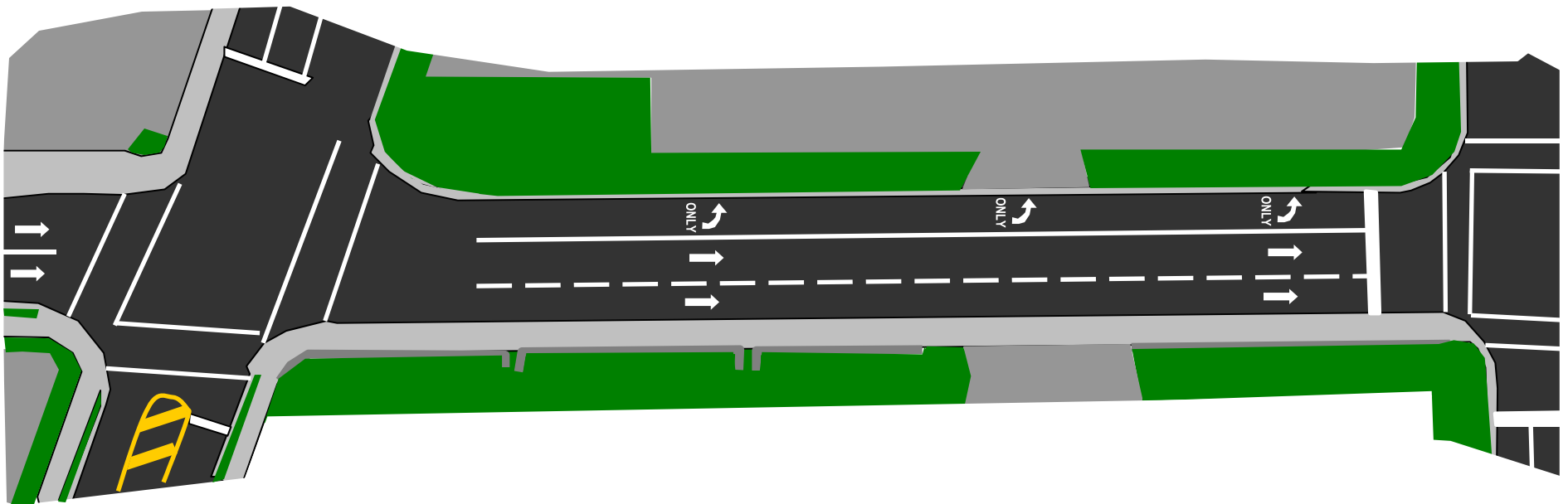

Thomasville to Gadsden - Existing

6th Avenue Pedestrian Enhancements

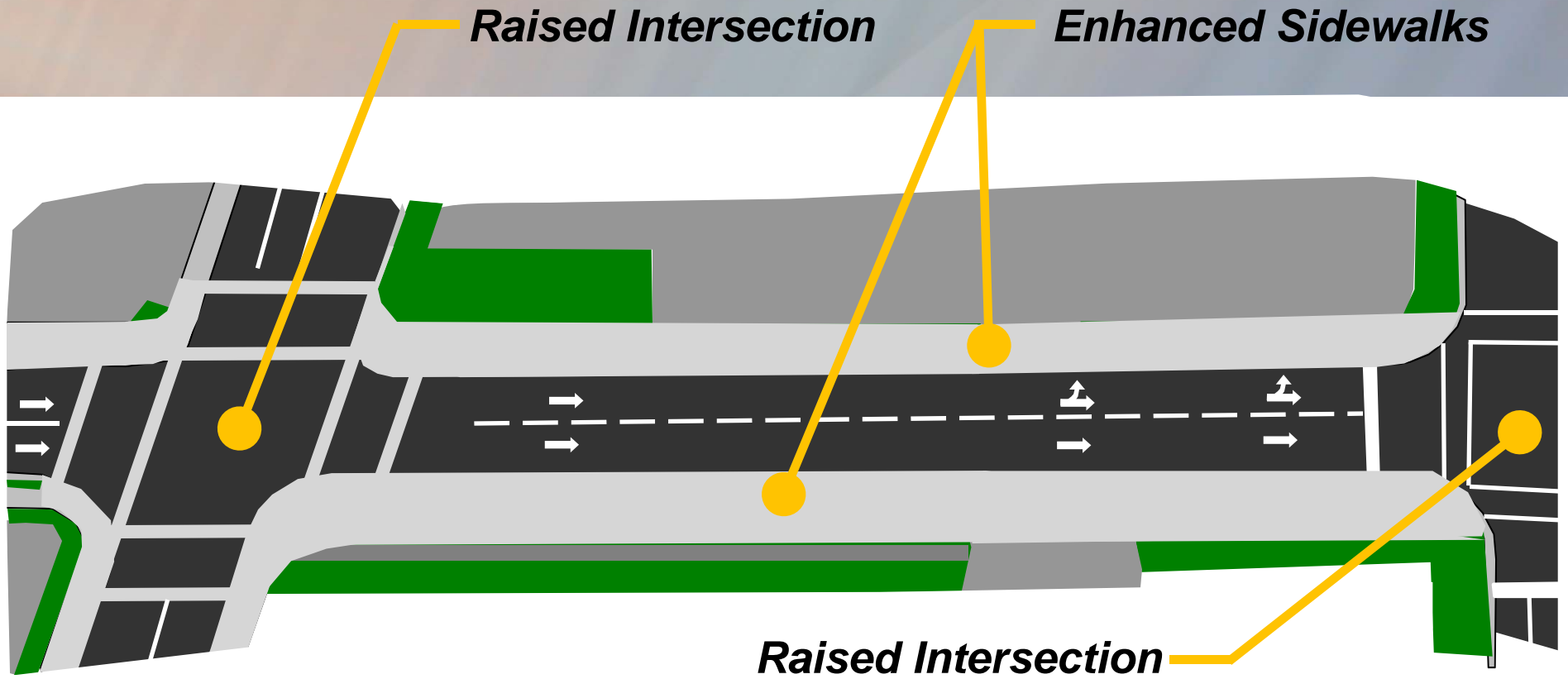

Thomasville to Gadsden - Proposed

6th Avenue Pedestrian Enhancements



- *Enhances pedestrian environment*
- *Defines pedestrian area*
- *Reduces speeds at intersection*
- *Can improve drainage options*

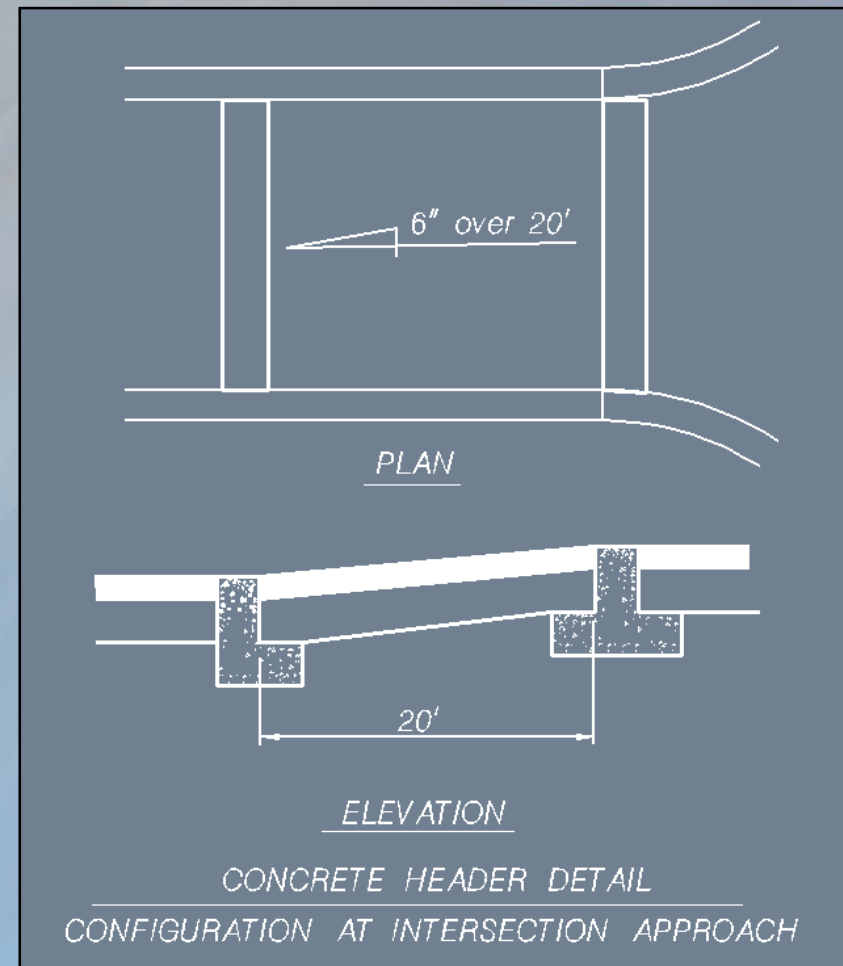
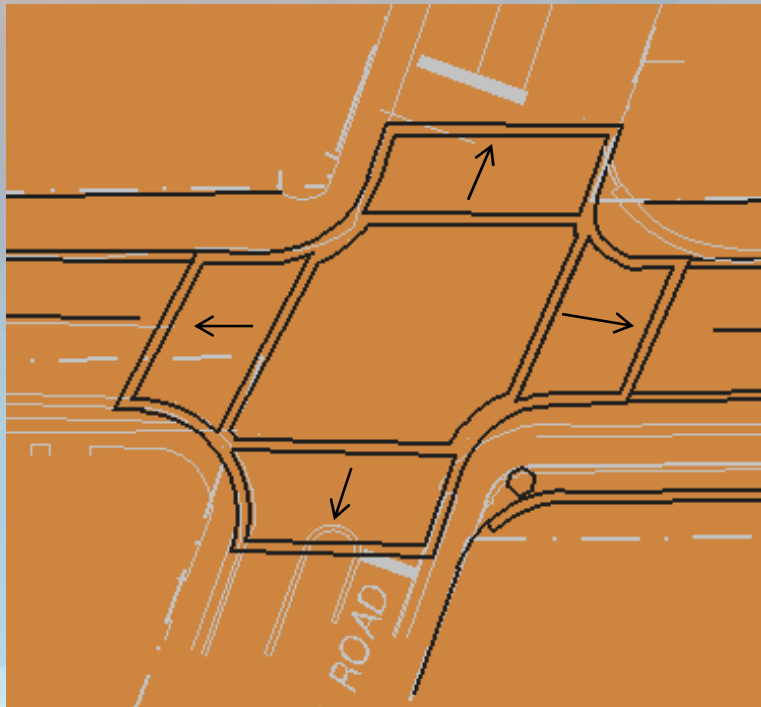

6th Avenue Pedestrian Enhancements

“In Cambridge, MA, motorists yielding to pedestrians crossing at raised intersections went from approximately 10 percent before installation of raised intersections to 55 percent after installation”

- PEDSAFE: Pedestrian Safety Guide (Federal Highway Administration)

6th Avenue Pedestrian Enhancements

Branding, place making opportunity....



What would this application look like along 6th Avenue?

6th Avenue Pedestrian Enhancements

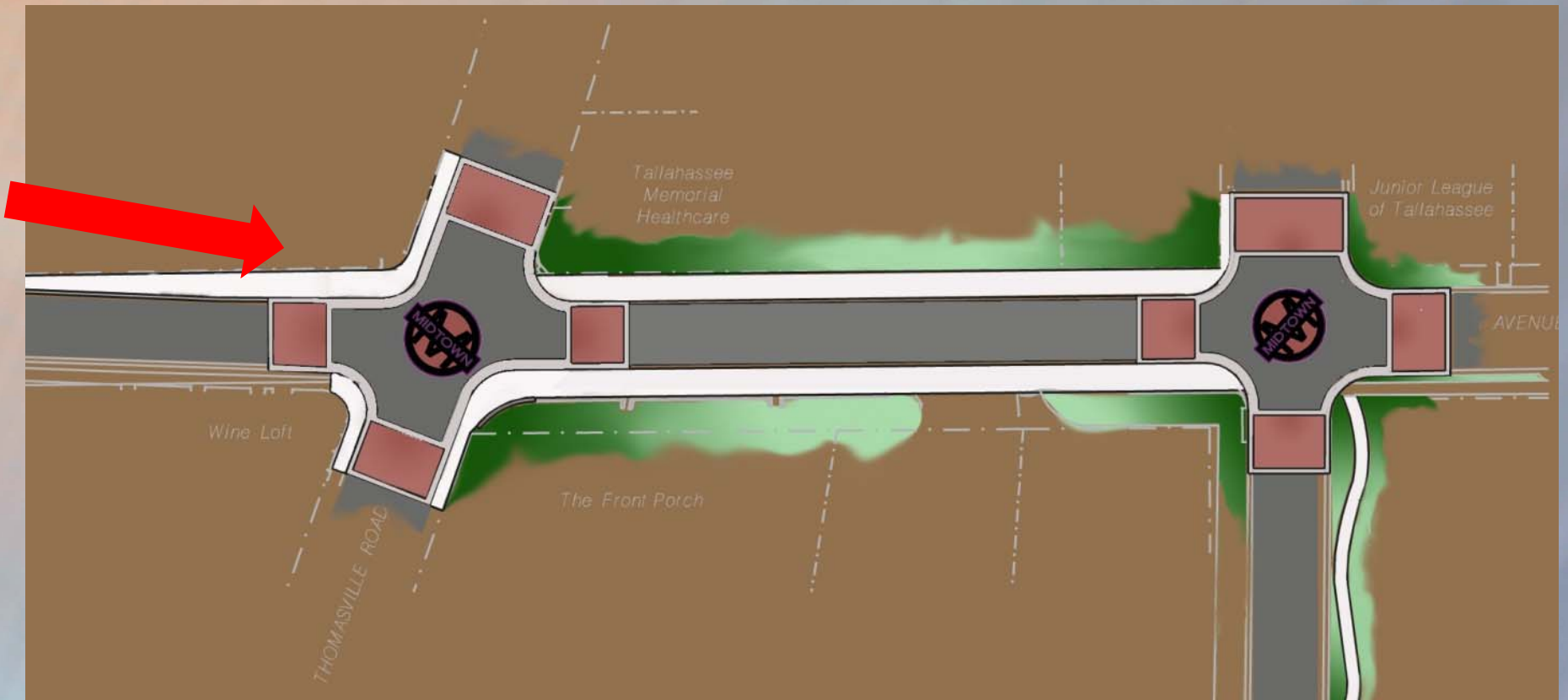

6th Avenue Pedestrian Enhancements



Existing Intersection – 6th Avenue Looking East at Thomasville Road

6th Avenue Pedestrian Enhancements



Proposed Raised Intersection – 6th Avenue Looking East at Thomasville Road

6th Avenue Pedestrian Enhancements

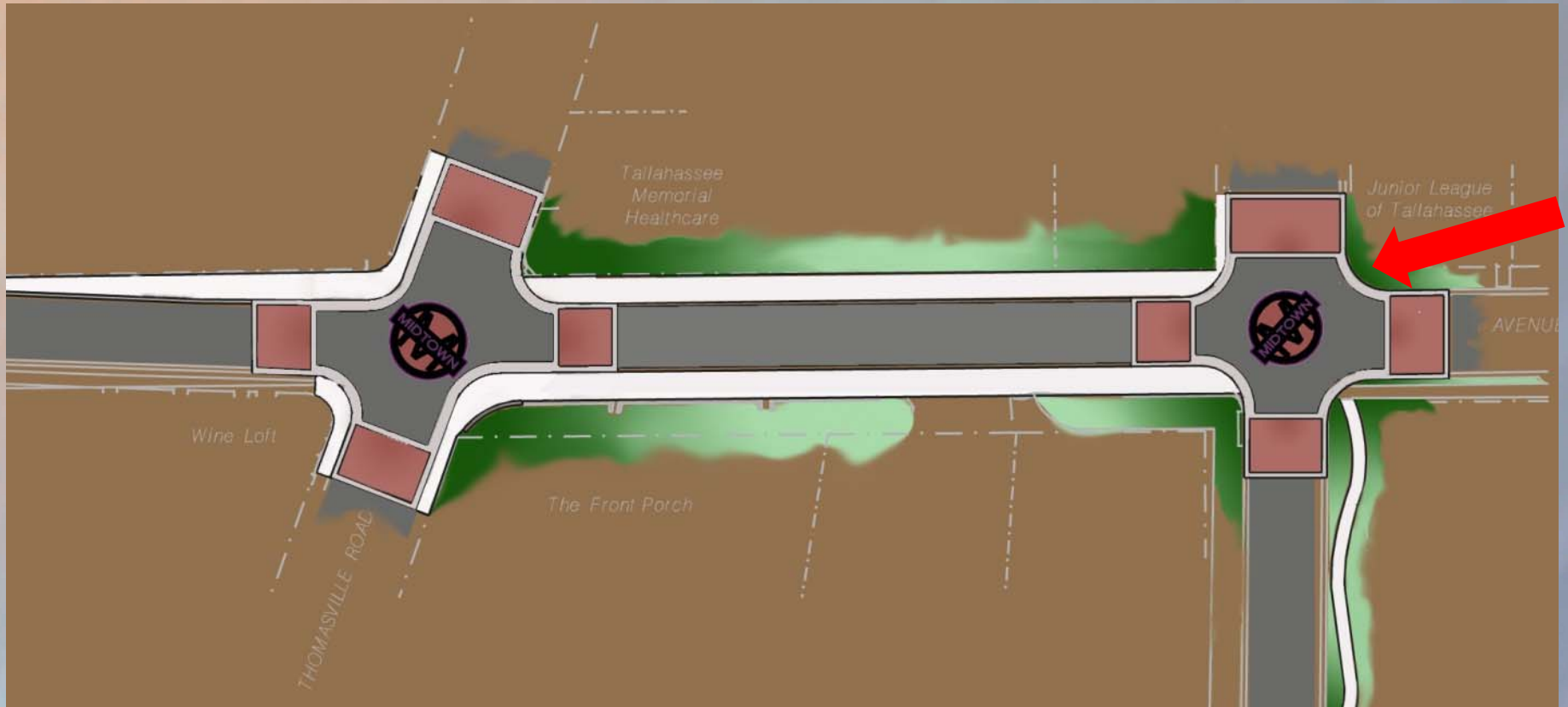

6th Avenue Pedestrian Enhancements



Existing Intersection – 6th Avenue Looking West at Gadsden Street

6th Avenue Pedestrian Enhancements



Proposed Raised Intersection – 6th Avenue Looking West at Gadsden Street

6th Avenue Pedestrian Enhancements

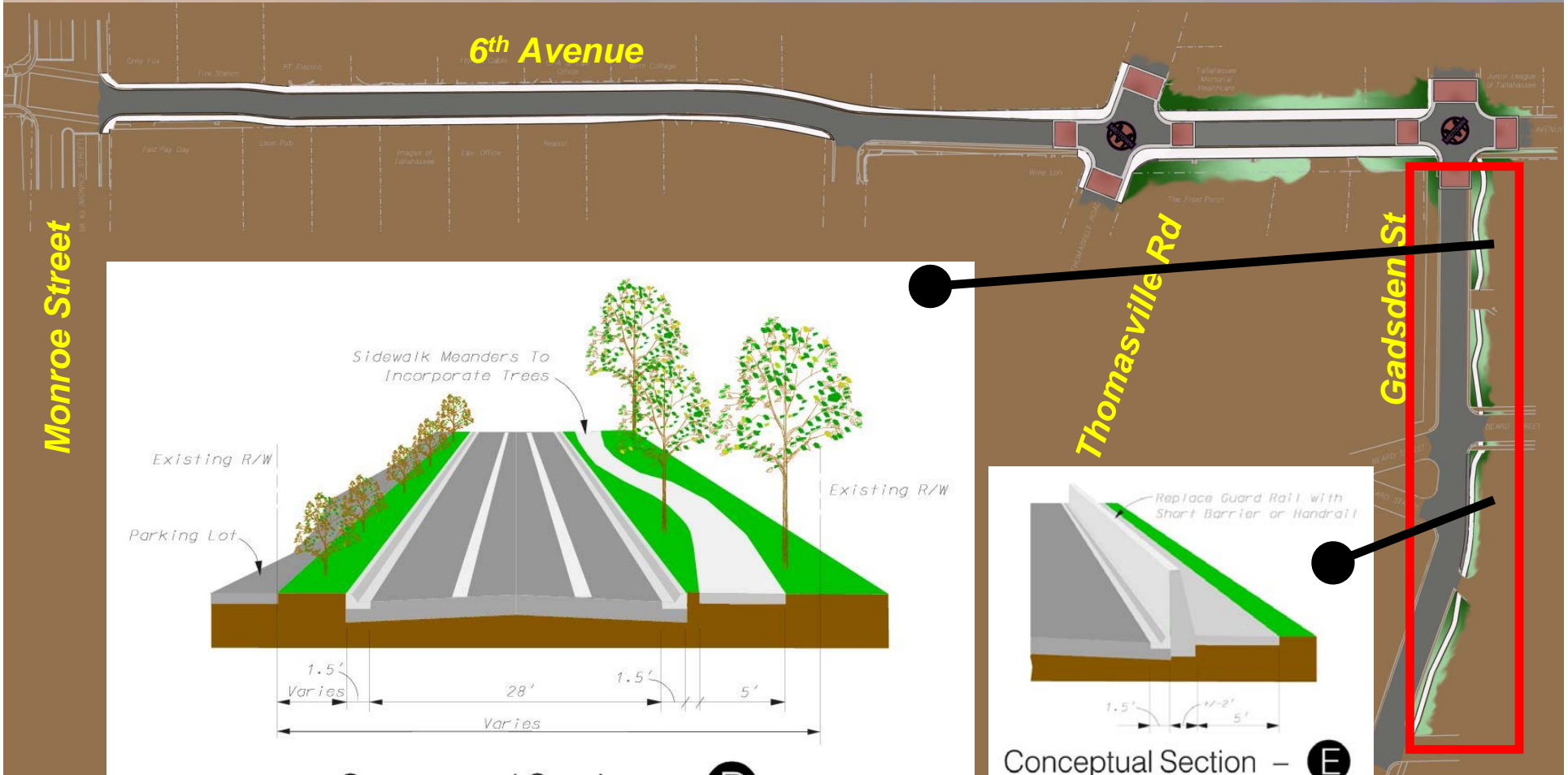

Monroe Street

6th Avenue

Thomasville Rd

Gadsden St

Conceptual Section - D

Conceptual Section - E

6th Avenue Pedestrian Enhancements

Preliminary Estimated Cost

Estimate Costs for 6th Avenue and Gadsden Street Pedestrian Projects

	Unit	6th Ave. - Preferred Concept Alternative		
		Number	Cost Per	Total Item Cost
Remove Asphalt Pavement	SQ YD	1,100	14.00	\$15,400.00
Remove Concrete	SQ YD	1,000	12.00	\$12,000.00
Remove Dispose C&G	LF	2,000	12.00	\$24,000.00
Saw cut Exist Pavement	LF	1,200	4.00	\$4,800.00
Concrete Sidewalk (6")	SQ YD	1,700	52.00	\$88,400.00
Type F C & G	LF	2,000	22.00	\$44,000.00
Raised Intersection	per	2	80,000.00	\$160,000.00
Mast Arm Signals	per	2	100,000.00	\$200,000.00
Replace retaining Wall	LF	30	100.00	\$3,000.00
Single Pole removal	per	2	800.00	\$1,600.00
Utility Relocation	LS	1.00	80,000.00	\$80,000.00
Standard Milling (3")	SQ YD	3,300.00	3.00	\$9,900.00
Resurface 3" Asphalt *	Ton	550.00	100.00	\$55,000.00
Miscellaneous Pavement Marking	LF	1,500.00	6.00	\$9,000.00
Miscellaneous Sodding	SQ YD	1,000.00	7.00	\$7,000.00
Sub-Total				\$714,100.00
Design (15%)				\$107,115.00
Contingency (20%)				\$142,820.00
Total Estimated Costs				\$964,035.00

*-Based on 110 lbs per sq yd

	Unit	Gadsden Street Sidewalk		
		Number	Cost Per	Total Item Cost
Right of Way Survey	per	1	2,500.00	\$2,500.00
Concrete Sidewalk (6")	SQ YD	300	52.00	\$15,600.00
Utility Relocation	LS	1.00	6,000.00	\$6,000.00
Remove Guardrail	LF	85.00	15.00	\$1,275.00
Retaining Wall	LF	100	100.00	\$10,000.00
Miscellaneous Sodding	SQ YD	500.00	7.00	\$3,500.00
Sub-Total				\$38,875.00
Design (15%)				\$5,831.25
Contingency (20%)				\$7,775.00
Total Estimated Costs				\$52,481.25

Total Estimated Costs for 6th Ave. and Gadsden Street Projects	\$1,016,516.25
---	-----------------------

6th Avenue Pedestrian Enhancements

Thank You for your Time!



URS